



## Rackham Road, Worthing, BN13 1LH - £375,000

Aspire Residential are pleased to bring to the market this three bedroom semi detached bungalow in Tarring. This property requires modernisation, however could offer someone the opportunity to create a fantastic home by adding their own stamp. This sought after location offers popular schools including 'Thomas A Beckett', transport links and local shops. Other benefits include a garage, south facing garden and no forward chain. Call us today to book your viewing.

### Key Features:

- **Semi Detached Bungalow**
- **In Need Of Modernisation**
- **Three Bedrooms**
- **South Facing Garden**
- **EPC - D**
- **Garage**
- **No Forward Chain**
- **Off Road Parking**

[www.aspireresidential.co.uk](http://www.aspireresidential.co.uk)

28 Goring Road , Worthing, BN12 4AD

01903 259961 [info@aspireresidential.co.uk](mailto:info@aspireresidential.co.uk)



### **Hallway**

Access to loft. Metre box. Airing cupboard. Radiator. Carpets.

### **Bedroom 2** 11' 9" x 9' 11" (3.58m x 3.02m)

Double glazed window to front with radiator below. Carpets.

### **Bedroom 3** 8' 8" x 8' 2" (2.64m x 2.49m)

Double glazed window to front with radiator below. Carpets.



### **Bedroom 1** 13' 2" x 11' 4" (4.01m x 3.45m)

Double glazed window to front with radiator below. Built in wardrobe and draws. Carpets.

### **W/C**

Double glazed frosted window to side. Chain flush toilet.

### **Bathroom**

Double glazed frosted window to side. Fully tiled walls. Panel enclosed bath. Pedestal wash hand basin. Radiator. Carpets.



### **Lounge** 15' 1" x 11' 5" (4.59m x 3.48m)

Double glazed doors out to garden with windows to both sides. x2 Radiators. TV point. Phone point. Carpets.

### **Kitchen** 11' 9" x 9' 5" (3.58m x 2.87m)

Double glazed window to rear and side. Matching range of wall and base units. One and half Bowl sink inset to worktop. Integrated appliances include a fan assisted oven and four ring gas hob. Space for appliances. Radiator.

**South Facing Garden**

Laid to lawn with shrubbery.

**Garage**

Flat roof garage with up and over door.

**Off Road Parking**

For multiple cars.







### Floor Plan

Approx. 76.9 sq. metres (827.7 sq. feet)

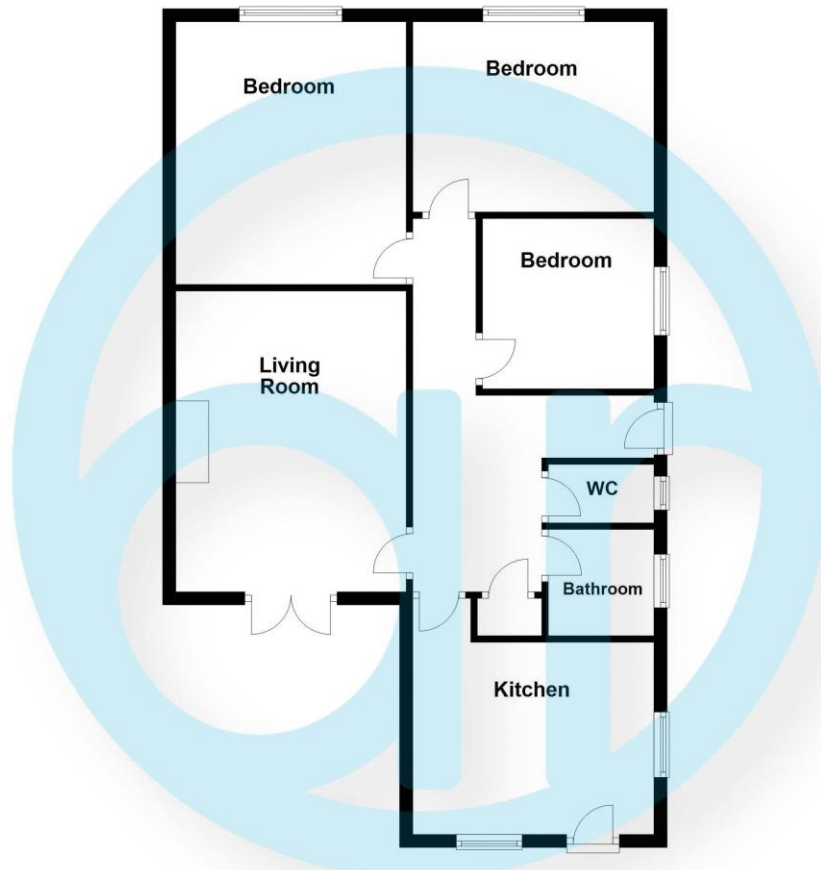

Total area: approx. 76.9 sq. metres (827.7 sq. feet)

[www.aspireresidential.co.uk](http://www.aspireresidential.co.uk)

28 Goring Road , Worthing, BN12 4AD  
01903 259961 info@aspireresidential.co.uk